

Stokes School's Operational Response to COVID-19

Elsie Whitlow Stokes CFPCS Operations Protocols and
Procedures under Covid-19 - August 25th, 2021



Housekeeping Items

- Session will be recorded. Please turn off your camera if you do not want to be recorded.
- Please drop questions in the chat
- We will publish a Frequently Asked Questions document

Creation/Revision of Stokes School Guidance

- We review national guidance for elementary schools from the Center for Disease Control and Prevention (CDC) and local guidance from DC Health
- We've collaborated with other operational leaders across the nation, and continue to consult with other operating groups across the nation as well as local operations school leaders
- We continue to review city guidance on safety re-entry and participate in biweekly calls with the Department of Health - as well as weekly and bi-weekly calls with DME/OSSE/PCSB
- Sharon Bostic, a consultant with DCPCSB, conducted walk through the buildings and provided us with feedback on our set up and procedures - and guidance on best practices
- Chris Lalik, consultant with DCPCSB, on emergency response has also walked through and provided feedback on different aspects of safety while on the buildings

Stokes School 8 Steps to Safety Strategy

Stokes 8 steps to safety strategy was developed by using guidance from CDC, city guidance in addition to consultancy with other school districts, and taking in consideration our own experience as we reopened in January 2021 through out the end of the school year. These key strategies were put in place and will remain in place until further notice as it is our believe it is the safest way to keep our community safe.

- **Healthy Hygiene Practices** (hand washing, hand sanitizing, cover mouth when coughing or sneezing)
- **Face Covering & PPE** (face shield, disposable masks, gowns and gloves)
- **Social Distancing** (keep 3 feet apart and 6 feet when feasible)
- **Health survey & Temperature checking** (100%daily screening and temperature checking)
- **Cleaning and Disinfecting** (disinfecting all high touch surfaces on a regular basis and usage of electrostatic guns for playground)
- **Student and Staff testing** (100% SHIELD-T3 testing for all students and staff)
- **Covid Response Protocols** (ED, DOO, CD, DTL, OM)
- **Vaccination.**(No vaccines available yet to children under 12 years of age)

Important Safety Measures Put In Place for Re-Entry Brookland

- Procured all necessary PPE for both staff and students
- 2 modular classrooms to be installed to increase the amount of available for our scholars
- Removed furniture from classrooms to provide maximum social distancing for our scholars and staf
- Water fillers on all floors
- Purchased additional picnic tables to maximize outdoor eating spaces
- Procured electrostatic guns to disinfect
- We have 2 additional day porters
- Ionization throughout the building



Modular Classrooms

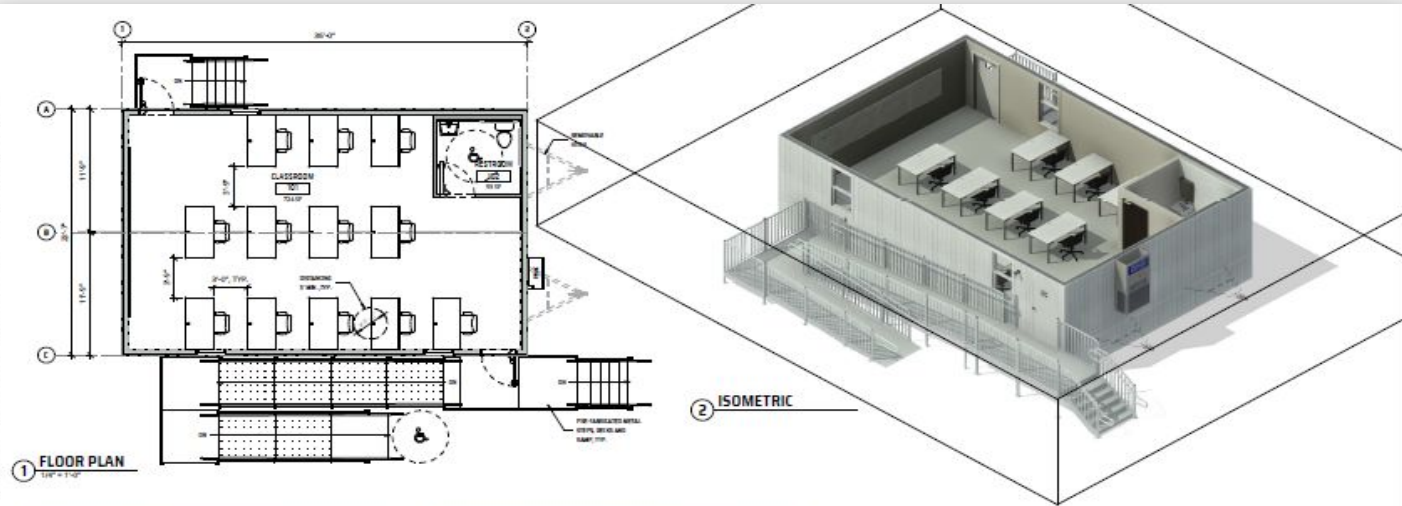

EXTERIOR VIEW 1



EXTERIOR VIEW 2



INTERIOR VIEW 1



INTERIOR VIEW 2

EXTERIOR LOADING (NET)			
SPACE NAME	WIDTH	DEPTH	AREA
CLASSROOM	10'0"	10'0"	100.00
STORAGE	10'0"	10'0"	100.00

MATERIALS AND FINISHES:
 FRAME: ALUMINUM
 FLOOR: VCT
 CEILING: ACP
 EXTERIOR WALLS: VINYL
 ROOF: BURR

BUILDING SYSTEM CLASSROOM
 BUILDING SYSTEM CLASSROOM
 OCCUPANCY: 100
 OCCUPANCY: 100

GENERAL NOTES:
 1. EXTERIOR DIMENSIONS TO FACE OF STUD.
 2. EXTERIOR FINISHES TO BE AS SHOWN OR AS NOTED.
 3. ALL NEW WALLS LOCATIONS SUBJECT TO CHANGE AND SUPPLEMENTARY NOTES.
 4. ELECTRICAL PANELS LOCATED AS SHOWN OR AS NOTED.
 5. SEWERAGE PUMP/STATION PROVIDED BY OWNER.
 6. STAIRS, ELEVATOR AND RAMP SHALL BE PROVIDED BY OWNER.
 7. SUBJECT TO APPROVAL BY LOCAL JURISDICTION.

EQUIPMENT SCHEDULE			
ITEM NAME	QUANTITY	DESCRIPTION	QTY
PK. K	1	PK. K, PAKING, PAKING, PAKING	12
WTS	1	WTS, QUANTITY 1000 WHITEBOARD	1
WTS	1	WTS, QUANTITY 1000 WHITEBOARD	1

PRELIMINARY DRAWING NOT FOR CONSTRUCTION

Important Safety Measures Put In Place for Re-Entry East End

- Procure all necessary PPE for both staff and students
- Cleaning maintenance on MERV 13 filters
- Water fillers in both floors
- Removed furniture from classrooms to provide maximum social distancing for staff and students
- Purchased additional picnic tables to maximize outdoor eating space (backordered)
- Procure electrostatic guns to disinfect
- Clean and disinfect on a daily basis focusing constantly on high touch surfaces
- We have 1 additional day porter to support the additional cleaning/disinfecting protocols

Student and Staff Covid-19 Testing

- Stokes School is aiming to test 100% staff and students weekly while the transmission rate is high. We will continue to watch the health indicators and reassess/adjust as necessary
- Stokes School continues to partner with Shield-T3 lab to provide clear saliva PCR COVID-19 test (link at the bottom of of this slide)
- Operations will continue to observe testing
- Testing will be done first thing on Mondays (7:30 am -9:00 am)
- Should a case arise, you will be notified immediately by a Covid response team member (ED/DOO/CD)
- Health/Medical information is strictly confidential and protected by HIPAA

Student and Staff Covid-19 Testing Continuation

- We need for all families to submit the Family Agreement prior to Monday. Please email to:
- BK: Mirsa Lopez at mirsal@ewstokes.org
- EE: Nancy Cruz at nancyc@ewstokes.org
- **Family Agreement**
https://09bba490-8ad5-499b-9d48-64d8a6ae301c.filesusr.com/ugd/d9f106_f244494913554047a4ffbaf3cab21dcd.pdf
- **ShieldT3**
https://23a5e98b-8675-4f13-8091-5e816da7b7f2.filesusr.com/ugd/d9f106_7b96cbf1c9f9499faa7300536138dc65.pdf

Monday Testing Day



A quick look at BK classes

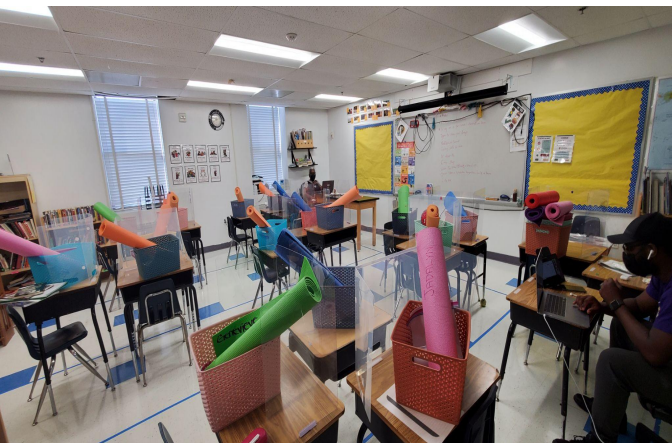

A Quick look at EE Classes



COVID-19 Response Protocol

The Covid Response Protocols are the specific steps that must be followed if a staff member/ student at Stokes School develops COVID-19 symptoms, tests positive for COVID-19 Or comes into direct contact with an individual who tests positive.

- Receive COVID case notification & takes initial safety actions (ED/CD/DOO/DTL)*
- School leaders notify COVID response Team (ED/CD/DOO/OM)
- COVID Response Team starts contact tracing (OM/DOO)
- COVID Response Team and leadership determine decision on quarantine, closures and execution next steps (ED/CD/DOO)
- Leaders, COVID Response Team, and our contact tracer communicate with all involved individuals (ED/CD/DOO)
- Leaders, COVID Response Team, and our contact tracer continue to follow-up and monitor the situation (Assigned team member)
- Let's review some possible scenarios

*ED= Executive Director, CD=Campus Director, DOO=Director of Operations, DTL=Director of Teaching and Learning, OM = Operations Manager



01

Student or Staff test positive for Covid-19

- Parent or staff member communicates immediately with the covid-19 response team
- ED reports to DOH
- Contract tracing begins (DOO, OM)
- ED or CD emails families and staff members
- The pod shuts down for at least 24 hours

02

Student or Staff test positive through Stokes Pool Testing

- DOO contacts ED/CD immediately
- CD/DOO reaches out to the family or staff member
- Contract tracing begins (DOO, OM)
- ED reports to DOH
- ED or CD emails families and staff members
- The pod shuts down for at least 24 hours

03

Student or Staff Develops symptoms of Covid-19 while on the school premises

- Student is taken immediately to the Isolation room. Parent/guardian is contacted to come pick up scholar. Scholar takes a PCR test and is not able to return to school until cleared by a doctor or negative PCR
- A staff member will leave the premises immediately and go get tested. Staff member is not able to return to work until they are cleared by a doctor or neg. PCR
- ED/CD emails staff/families

Quarantine

- If a scholar must quarantine due to a positive test result or close contact with a COVID positive individual, remote learning will be available.
- Each classroom will be equipped with an [Owl camera](#)
- Scholars will be able to participate in class and engage with their teachers and peers until they can return to the classroom in-person.
 - Some classes are currently set up with Owls for remote learning
 - Others are in the process of setting up

A young woman with blonde hair and blue eyes is shown in a close-up, looking slightly to the right and speaking. She is wearing a green textured sweater. The background is a plain, light blue wall.

Effectively enable immersive distance or hybrid learning

Staff Non-Negotiable Protocols While on the School Premises Regardless of Vaccination Status

- All staff members must be vaccinated by September 19 (medical and religious exemptions)
- All staff members must submit the daily health screener and have temperature checked upon arrival. Anyone with a temperature higher than 100.4 will be sent home
- All staff members must practice healthy hygiene throughout the day
- All staff members must wear appropriate face coverings inside and outside the building, (unless in a room by themselves) The only exception is when eating or drinking
- All staff members must practice social distancing
- All staff members must participate in the weekly clear saliva PCR testing
- All staff members must leave the premises as soon as done with work and will not congregate outside the building

Student Non-Negotiable Protocols While on the School Premises

- All students will participate in 100% temperature checking upon arrival. Anyone with a temperature higher than 100.4 will be sent home
- All students will participate in the weekly clear saliva PCR testing
- All students will practice healthy hygiene throughout the day
- All students must wear appropriate face coverings inside and outside the building. If the face covering is visibly soiled, the school will provide another one. The ONLY exception to this is when eating or drinking
- All students must practice social distancing while moving around the building
- All students must be accompanied by an adult to use the restroom or go out to the playground area
- Students are not allowed to share any materials, including books. An individualized basket has been provided for all students

COVID-19 Staff Expectations

- Ensure they understand these measures and how to take action
- Follow these measures and inform school leaders when they are not being practiced
- Be aware of the symptoms, primarily knowing what to do, how and to whom they should report
- Find the most up to date DC Health Guidance for school reopening here:

[https://coronavirus.dc.gov/sites/default/files/dc/sites/coronavirus/page_content/attachments/COVID-19 DC Health Guidance For Schools Reopening 08.18.2021.pdf](https://coronavirus.dc.gov/sites/default/files/dc/sites/coronavirus/page_content/attachments/COVID-19_DC_Health_Guidance_For_Schools_Reopening_08.18.2021.pdf)

Any of these red flag symptoms	Or at least two of the following symptoms
Fever 100.4 or above	Fever measured or subjective An unusual amount of tiredness
Persistent Cough or shortness of breath	Chills, Muscle or body ache Headache
Loss of taste or smell	Sore throat Nausea or vomiting
	Runny nose or congestion Diarrhea





WHERE

WHAT

WHEN

WHY

HOW

WHO